

# Always there to help you

Register your product and get support at  
[www.philips.com/support](http://www.philips.com/support)

SRP2018



## User manual

**PHILIPS**



# Contents

---

<b>1</b>	<b>Your universal remote</b>	<b>2</b>
	Introduction	2
	Overview of the universal remote	2
	Supported devices	3

---

<b>2</b>	<b>Get started</b>	<b>4</b>
	Insert batteries (not included)	4
	Set up the universal remote	4

---

<b>3</b>	<b>Notice</b>	<b>7</b>
	Disposal of your old product and battery	7

---

<b>4</b>	<b>Service and support</b>	<b>8</b>
	Frequently asked questions	8
	Need help?	8

# 1 Your universal remote

Congratulations on your purchase, and welcome to Philips! To fully benefit from the support that Philips offers, register your product at [www.philips.com/welcome](http://www.philips.com/welcome)

## Introduction

With the universal remote, you can operate up to 8 different devices.

## Overview of the universal remote

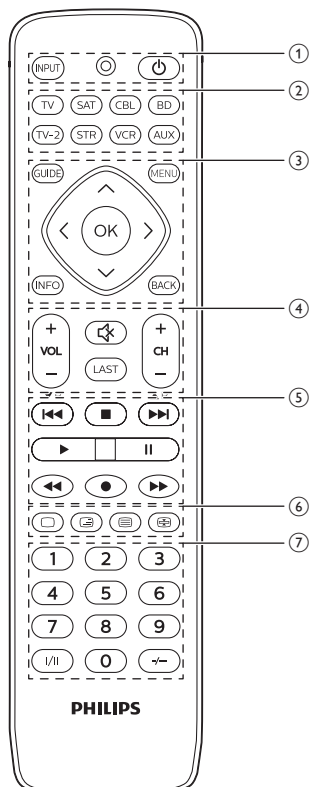











- ① **INPUT**: select available source inputs (antenna, cable, etc.).
  - : LED indicator
  - ⏻ : power on or off.
- ② Device selection buttons
- ③ **GUIDE**: displays the program guide.  
**INFO**: displays on-screen channel information.  
**MENU**: menu on or off.  
**BACK**: exit from the menu.  
**OK**: confirm your selection.  
▲ / ▼ / ◀ / ▶ : up/down/left/right.
- ④ **VOL+/-**: adjust the volume.

**CH+/-**: go to the next/previous channel.

 : mute

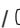
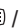
**LAST**: return to the previous tuned channel.

- ⑤  : previous track
  -  : stop
  -  : next track
  -  : play
  -  : pause
  -  : rewind
  -  : record
  -  : fast forward
- ⑥  /  /  /  : teletext off/teletext mix/teletext on/teletext hold
- ⑦ Digit buttons
  - I/II**: select the audio channel.
  - /--**: select between one and two-figure channel numbers.

---

## Supported devices

Device name	Description
<b>TV/TV-2</b>	TV, DTV
<b>CBL/SAT</b>	Cable box, satellite receiver, IPTV, DVR, HDTV decoder and TiVo
<b>BD</b>	DVD player/recorder, Blu-ray player
<b>STR</b>	Streaming devices, Apple TV, Roku, Sony, WD TV, Netgear
<b>VCR</b>	Video cassette player/ recorder
<b>AUX</b>	Auxiliary equipment, media center PC, others

## 2 Get started

### Insert batteries (not included)

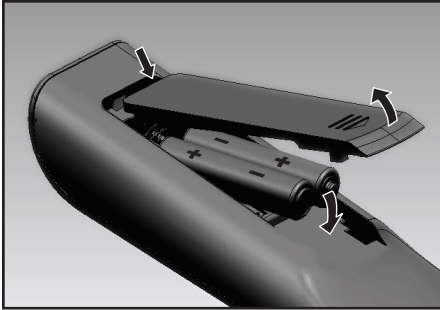

#### Warning

- Check the battery polarity when inserting in the battery compartment. Incorrect polarity may damage the product.

#### Caution

- Risk of explosion! Keep batteries away from heat, sunshine or fire. Never discard batteries in fire.
- Risk of decreased battery life! Never mix different brands or types of batteries.

#### Note

- When you replace the batteries, all user settings will be retained in the memory of the universal remote for 5 minutes.

### Set up the universal remote

You must first set up the universal remote before operating your devices.

### Manual registration

- 1 Switch on your device.

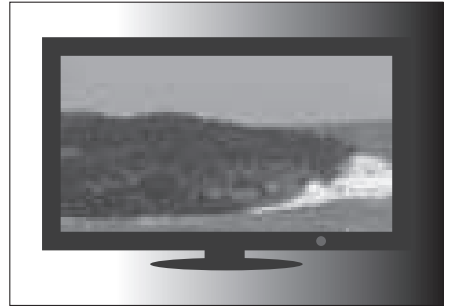

- 2 Press and hold the device selection button (e.g. TV) for 5 seconds until the red LED is on.



- 3 Look up the 5-digit code for your brand in the code list. Codes are listed by the device type and brand name. The most popular code is listed first.

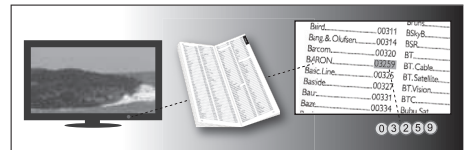

- 4 Enter the first 5-digit code using the digit buttons.

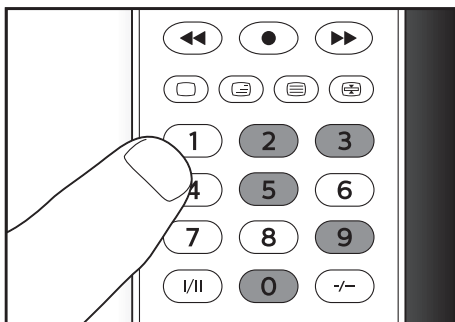

- 5 If the light is off, a valid code is saved. Otherwise, the light will flash once, and then remains on for code re-entry.

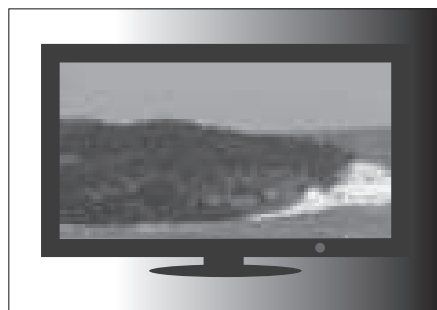

- 2 Press and hold the device selection button (e.g. TV) for 5 seconds until the red LED is on.

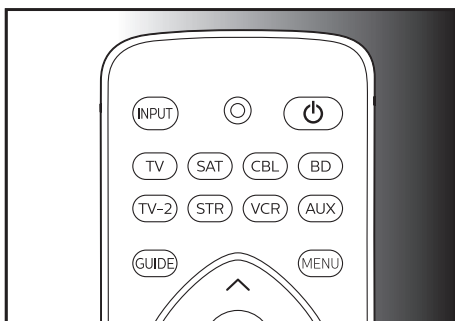

- 6 Operate the device with the universal remote. If your device responds correctly, it means you have entered the right code. Otherwise, repeat from step 2, and enter the second code on the list.

- 3 Point at your device with the universal remote. Then press and release **⏻** to start searching the code for your brand. A different infrared signal is sent every 2 seconds as the universal remote searches, indicated by a red flash.

#### Note

- It is possible sometimes that your device only responds to some of the buttons. In such case, set up with the next code in the code list, and try operating your device again.
- Each device button can be used to set up any device. Eg. you may setup a TV using the **BD** device button.

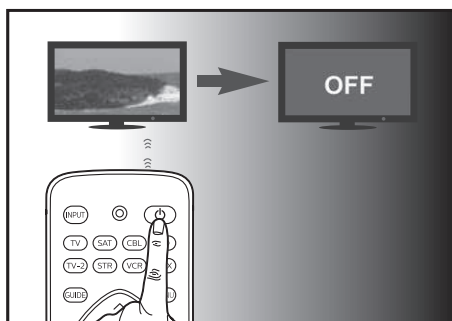

## Auto registration

- 1 Switch on your device.

- When the device is off, **immediately** press and release **OK** to save the code. The red LED indicator will turn off.

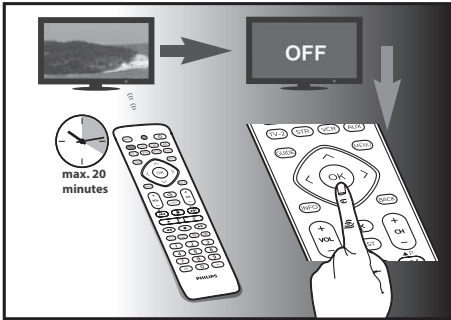

- Operate the device with the universal remote. If your device responds correctly, it means you have saved the right code.

#### Note

- Auto registration can be reversed, by pressing and releasing **⏻** once more during the auto registration process. This is helpful if you missed out the chance to press **OK** within 2 seconds. Make sure that the device is first powered on again.
- Repeat the same procedures to set up other devices.
- It is possible sometimes that your device only responds to some of the buttons. In such case, set up with the next code in the code list, and try operating your device again.



# 3 Notice

## Disposal of your old product and battery



Your product is designed and manufactured with high quality materials and components, which can be recycled and reused.



This symbol on a product means that the product is covered by European Directive 2012/19/EU.



This symbol means that the product contains batteries covered by European Directive 2013/56/EU which cannot be disposed of with normal household waste.

Inform yourself about the local separate collection system for electrical and electronic products and batteries. Follow local rules and never dispose of the product and batteries with normal household waste. Correct disposal of old products and batteries helps prevent negative consequences for the environment and human health.

### Removing the disposable batteries

To remove the disposable batteries, see section 'Insert batteries'.



When this logo is attached to a product, it means a financial contribution has been paid to the associated national recovery and recycling system.

### Environmental information

All unnecessary packaging has been omitted. We have tried to make the packaging easy to separate into three materials: cardboard (box), polystyrene foam (buffer) and polyethylene (bags, protective foam sheet.) Your system consists of materials which can be recycled and reused if disassembled by a specialized company. Please observe the local regulations regarding the disposal of packaging materials, exhausted batteries and old equipment.

## 4 Service and support

---

You will find our contact details at the end of this user manual.

For online support, visit [www.philips.com/support](http://www.philips.com/support)

### Frequently asked questions

#### **My universal remote does not work at all.**

- Check if you have correctly setup the device with the right code.
- Check if you have pressed the corresponding device key for your device.
- Check if the batteries are inserted properly. If the battery level is low, replace the batteries.
- Check if your device is powered on.

#### **If several device codes are listed under the brand of my device, how can I select the correct device code?**

To seek the correct device code, test the codes one by one. The codes are sorted by popularity, and the most popular code is listed first.

#### **My device responds only to some of the commands.**

You have set a code for which only some commands work properly but some do not. Try other codes until most keys work properly.

---

### Need help?

We advise you to first read this user manual carefully. It helps you set up and use the universal remote.

If, however, you require extra information or have additional questions about setup, usage, warranty, etc of the SRP2018, you can always contact us.

When calling our helpline, make sure to have the SRP2018 at hand when you call, so that our operators can help you determine whether SRP2018 is working properly.





2016 © Gibson Innovations Limited. All rights reserved.  
This product has been manufactured by, and is sold  
under the responsibility of Gibson Innovations Ltd., and  
Gibson Innovations Ltd. is the warrantor in relation to  
this product.

Philips and the Philips Shield Emblem are  
registered trademarks of Koninklijke Philips  
N.V. and are used under license from  
Koninklijke Philips N.V.

UM\_SRP2018\_10\_EN\_V1.0  
wk1607

